

Courses & Dist:  
up Tuscarora

2884 W	28 1/4
836 W	20
815 W	31
859 E	38
South	20
839 W	27
859 W	11
822 W	17
877 W	16
854 W	44 1/2
864 W	21
273 3/4	

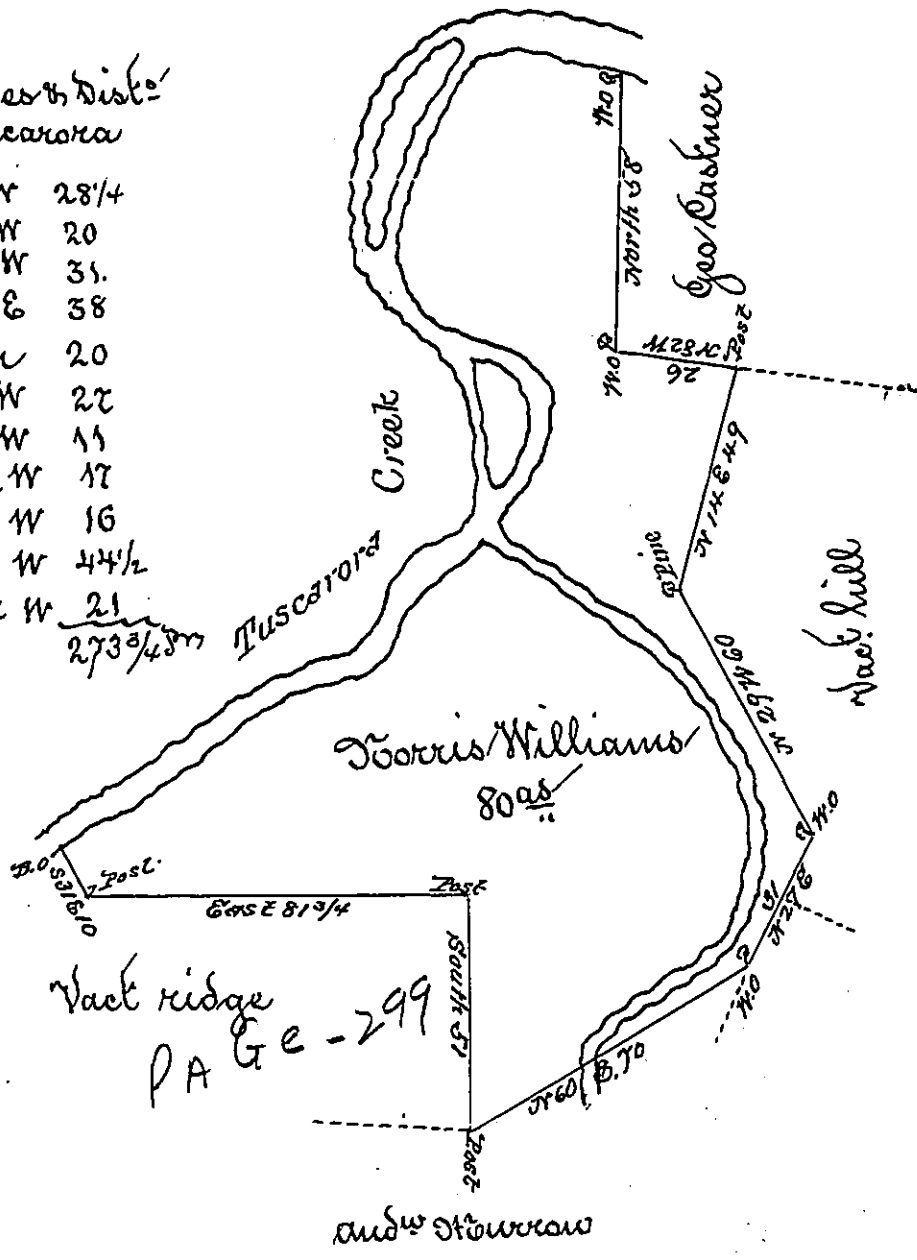

A draft of a tract of land situate in Millford Township, Millersburg County, containing eighty acres by the usual allowance of six per cent. for roads &c. surveyed for Torrur Williams March 22<sup>d</sup> 1791 in pursuance of a Warrant dated Jan<sup>y</sup>. 13<sup>th</sup> 1791

To Daniel Brodhead Esq<sup>r</sup>  
Surveyor Genl

James Harris D. S

IN TESTIMONY that the above is a copy of the original remaining on file in the Department of Internal Affairs of Pennsylvania, made conformably to an Act of Assembly approved the 16th day of February, 1833, I have hereunto set my Hand and caused the Seal of said Department to be affixed at Harrisburg, this second day of August 1898.

*James W. Patton*  
Secretary of Internal Affairs.